

Radial Thread Rolling

RE-13 - Radial Head

RADIAL THREAD ROLLING HEADS

STANDARD SHANK STYLE ILLUSTRATED
FLANGE MOUNTING ALSO AVAILABLE

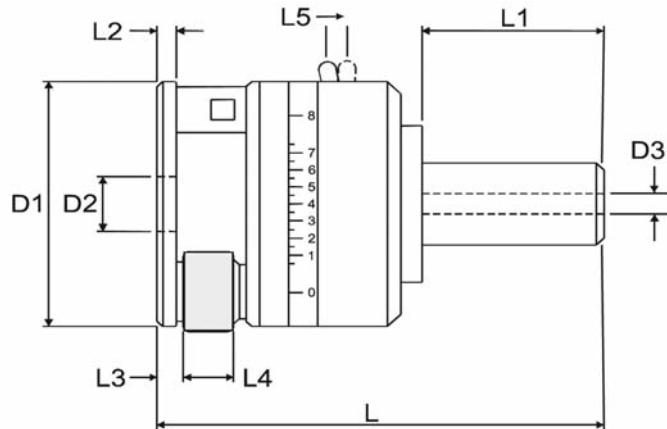

L4 = Maximum width of rolls

L5 = Stroke to trip head

Dimensions

| SHANK Ø OPTIONS | | D1 | D2 | D3 | L | L1 | L2 | L3 | L4max | L5 |
|-----------------|--------|-------|-------|-------|-------|-------|-------|-------|-------|-------|
| 1, 1/4 - 1, 1/2 | inches | 4.921 | 1.260 | 0.492 | 7.622 | 3.150 | 0.315 | 0.323 | 0.968 | 0.118 |
| 30 - 40 | mm | 125 | 32.0 | 12.5 | 193.6 | 80.0 | 8 | 8.2 | 24.6 | 3 |

The following thread rolls may be ordered as standard on the RE-13 head

ISO Metric

Nominal Size x Pitch mm

| |
|-------------|
| M 10 x 0.75 |
| M 10 x 1 |
| M 10 x 1.25 |
| M 10 x 1.5 |
| M 12 x 1 |
| M 12 x 1.25 |
| M 12 x 1.5 |
| M 12 x 1.75 |
| M 14 x 1 |
| M 14 x 1.25 |
| M 14 x 1.5 |
| M 16 x 1 |
| M 16 x 1.5 |
| M 18 x 1 |
| M 18 x 1.5 |

Metric Taper

Nominal Size x Pitch mm

| |
|-------------|
| M 10 x 1 |
| M 12 x 1 |
| M 10 x 1.25 |
| M 12 x 1.25 |
| M 12 x 1.5 |
| M 14 x 1.5 |
| M 16 x 1.5 |
| M 18 x 1.5 |

Unified

Nominal Size x TPI

| |
|------------------|
| 7/16 x 14 UNC |
| 7/16 x 20 UNF |
| 7/16 x 28 UNEF |
| 1/2 x 13 UNC |
| 1/2 x 20 UNF |
| 1/2 x 28 UNEF |
| 9/16 x 18 UNF |
| 9/16 x 20 UN |
| 9/16 x 24 UNEF |
| 5/8 x 18 UNF |
| 5/8 x 24 UNEF |
| 1 1/16 x 24 UNEF |

Whitworth

Nominal Size x TPI

| |
|---------------|
| 7/16 x 18 BSF |
| 1/2 x 16 BSF |
| 9/16 x 16 BSF |
| 7/16 x 14 BSW |
| 1/2 x 12 BSW |

Whitworth Pipe BSP

Nominal Size x TPI

| |
|------------|
| G 1/8 x 28 |
| G 1/4 x 19 |
| G 3/8 x 19 |

Whitworth Pipe BSPT

Nominal Size x TPI

| |
|------------|
| R 1/8 x 28 |
| R 1/4 x 19 |
| R 3/8 x 19 |

American Pipe Taper

Nominal Size x TPI

| |
|--------------|
| 1/8 x 27 NPT |
| 1/4 x 18 NPT |
| 3/8 x 18 NPT |

American Pipe Dry-Seal

Nominal Size x TPI

| |
|---------------|
| 1/8 x 27 NPTF |
| 1/4 x 18 NPTF |
| 3/8 x 18 NPTF |

The range of sizes shown can normally be safely rolled on the RE-13 head. For thread forms other than those listed, please contact our technical department.

Thread rolls are supplied as standard to suit right hand heads. This refers to the direction of rotation of the spindle and not the thread itself. Both right and left hand threads can be rolled using the same head; only the rolls are changed.

